

# FIELD SINK - 6202

**Item:** \_\_\_\_\_



Unit may be pictured with some optional features.



**WARNING: Cancer and Reproductive Harm**  
- [www.P65Warnings.ca.gov](http://www.P65Warnings.ca.gov).

**6202** Two Station Field Sink

## STANDARD FEATURES

- **Free Standing fixture**
- Stainless steel lavatory countertop with closing lid.
- Lid opens to serve as backsplash with mirrors for each station.
- Carrying handles for easy transport.
- Adjustable feet to accomodate moderately rough ground space.
- Drop-in Oval Basin with Overflow.
- 3 Hole - 4" Centers for Deck Mounted Faucets.



## ► DESCRIPTION

Metcraft field sinks are the perfect choice for a mobile lavatory requirement. From disaster relief to job sites our field sinks have all the right features and are customizable to your specific use case. These fixtures are constructed from heavy gauge type 304 stainless steel with a satin finish.



## ► INSTALLATION

Our field sinks are free standing with no addition mounting hardware being required. Water supply and waste can be plumbed to suit your use case.

## DRAINS

- |  |             |   |
|--|-------------|---|
|  | <b>A270</b> | Grid drain with tailpiece.                        |
|  | <b>A261</b> | Grid drain with close elbow. (Required with A780) |
|  | <b>OF</b>   | Overflow. (Standard)                              |

## FAUCETS

-  **A306** 4" Faucet, blade handles, gooseneck spout with aerator.
-  **A307** 4" Faucet, regular spout with aerator.

## FIELD SINK - 6202

**Item:** \_\_\_\_\_

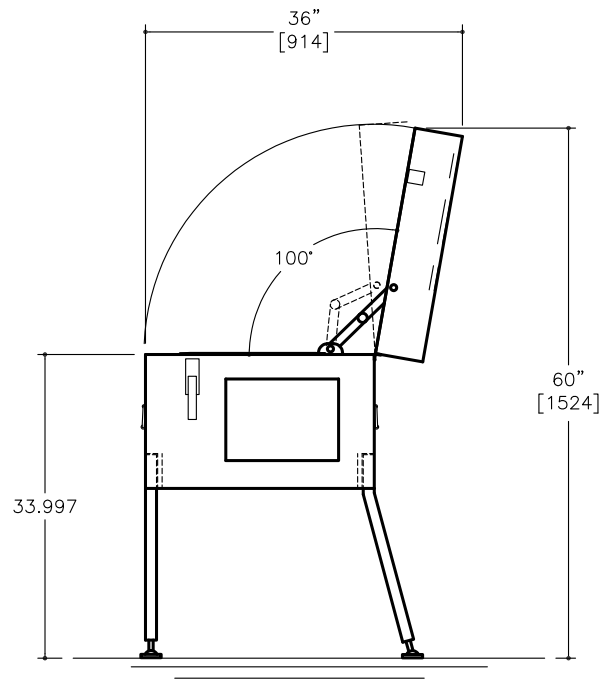
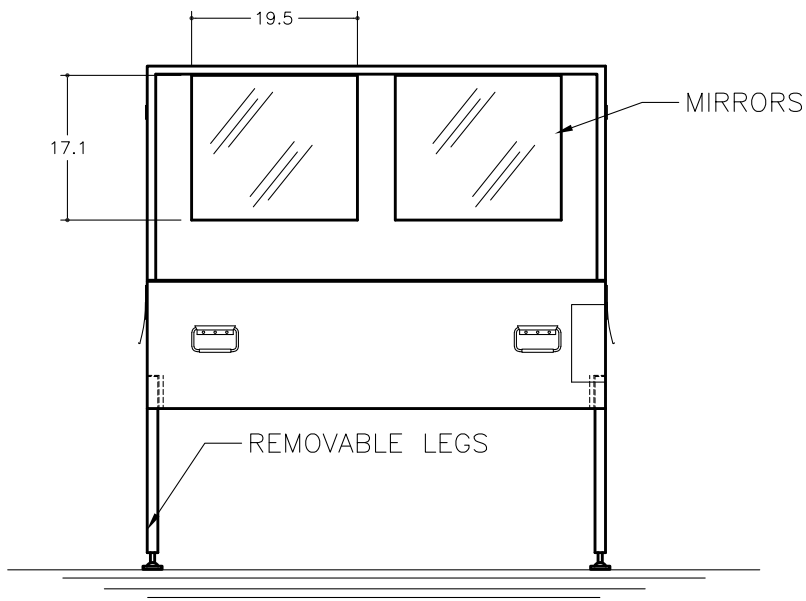

Due to continuous product improvement Metcraft reserves the right to make changes in design and specifications without prior notice. All dimensions should be verified with the factory for current information.

**APPROVED FOR  
MANUFACTURING**

**Company:** \_\_\_\_\_ **Name:** \_\_\_\_\_

**Signature:** \_\_\_\_\_ **Date:** \_\_\_\_\_