

PIT TOILET - 4300

Item: _____



Unit may be pictured with some optional features.

STANDARD FEATURES

- Floor mounted fixture.
- Toilet Bowl-
 - Elongated.
 - High polished integral seat.
 - Plastic Hinged Seat w/ Cover.

► DESCRIPTION

This Toilet Fixture is designed for high abuse areas without ready access to running water and sewage. The fixture is fabricated using 14 gauge type 304 stainless steel, seamlessly welded to form a vandal resistant unit. Exposed surfaces are polished to a satin finish, except for the integral seat which is polished to a bright finish.

► INSTALLATION

Pit toilets are mounted directly to the slab over the pit. A flange located 6" from the bottom of the fixture includes four holes for the mounting.



WARNING: Cancer and Reproductive Harm
- www.P65Warnings.ca.gov.

OPTIONS & ACCESSORIES

- ☐ **HO** Punched for hinged seat (By Others).
- ☐ **PCC** Powder Coat - Anti-microbial White.

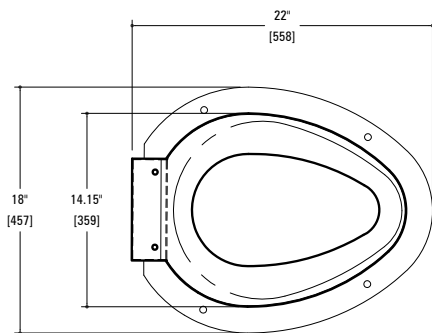

Due to continuous product improvement Metcraft reserves the right to make changes in design and specifications without prior notice. All dimensions should be verified with the factory for current information.

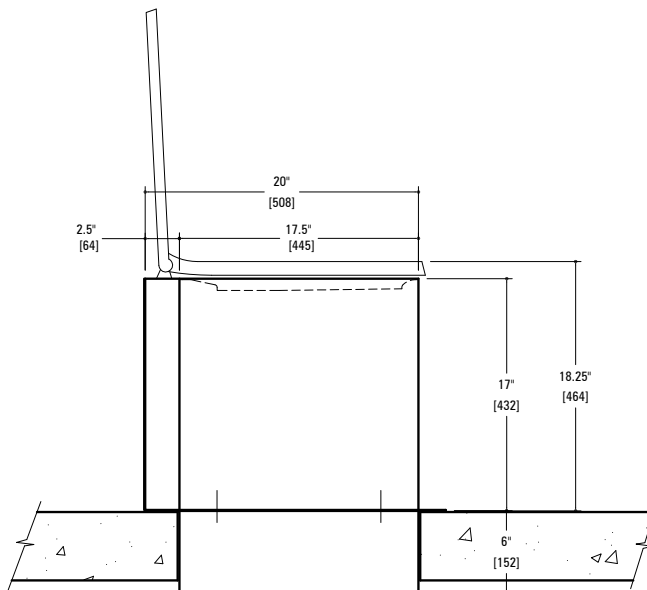

Note: Please contact us for a mounting template.

**APPROVED FOR
MANUFACTURING**

Company: _____ Name: _____
Signature: _____ Date: _____